

French Knitting Owl Doll

WARNING:
 CHOKING HAZARD – Small parts.
 Not for Children under 3 years.
 Plastic Needles Contain Functional Sharp Points.
 Use only under adult supervision.

A. CONTENTS

1 set of pre-cut coloured felt shapes, 24-pronged French knitting reel, crochet hook, yarn, stuffing, ribbon, glue, 2 plastic needles and detailed instructions.

B. MAKING THE OWL BODY

The Owl Doll is composed of tube-shaped knitwork, filled with stuffing and with added embellishments on top. The technique used is basic French Knitting. You may reuse the same tools and the same technique to make your own creations, such as scarves, dolls, ornaments, etc. Yarn and felt are available in local craft stores.

KNITTING THE BASE:

1. The first two rows of yarn form the base of your knitting work, and require a special technique. Take the yarn and start from the prong with a circle marked next to it. Wind the yarn once around the knitting reel in an "alternate prong" pattern, as shown in the diagram. Leave a loose end of about 10 cm and place it through the middle of the reel.
2. Wind the yarn through a second round, forming a complete circle this time. You will see that the two rows of yarn are now overlapped in an alternate prong pattern, as shown in the diagram.
3. Use the crochet hook provided. At the prong where two strands of yarn overlap, lift the bottom loop over the top
4. Hook it through the prong.
5. Repeat the same process until all the alternate prongs with overlapping yarn are done.
6. The base is now completed and will look like the one shown in diagram 6.

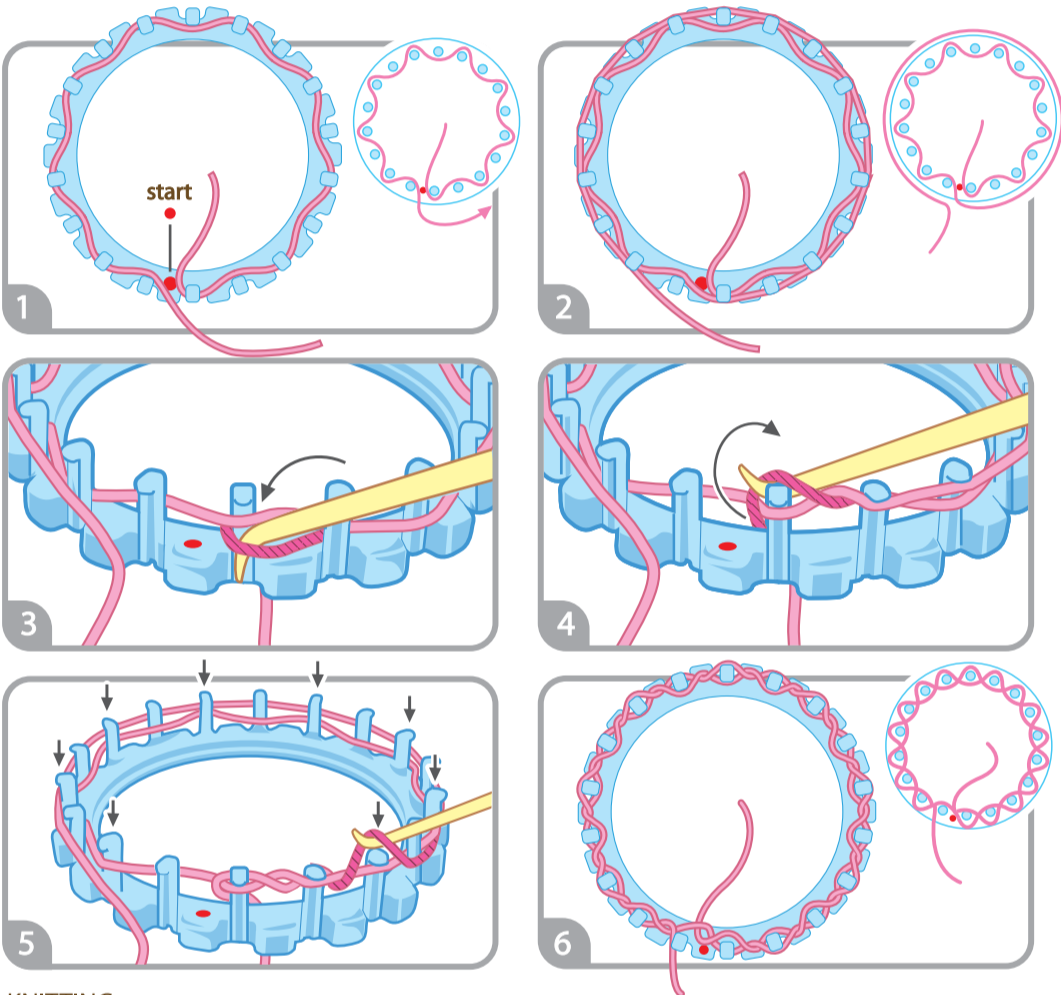

KNITTING:

7. Take the loose end and wind the yarn around the reel to form a complete circle.
8. Lift the bottom loop over the top and hook it, as in step 3. Repeat with ALL other prongs. Keep winding and knitting until about 35 rows of yarn are knitted. We recommend using the prong marked with a circle as a mark for counting each completed row of knitting. Please note: Do not wind the yarn too tight, as this will hinder knitting. Always gently pull down your knitwork when knitting. This will help properly maintain the shape of your knitwork.

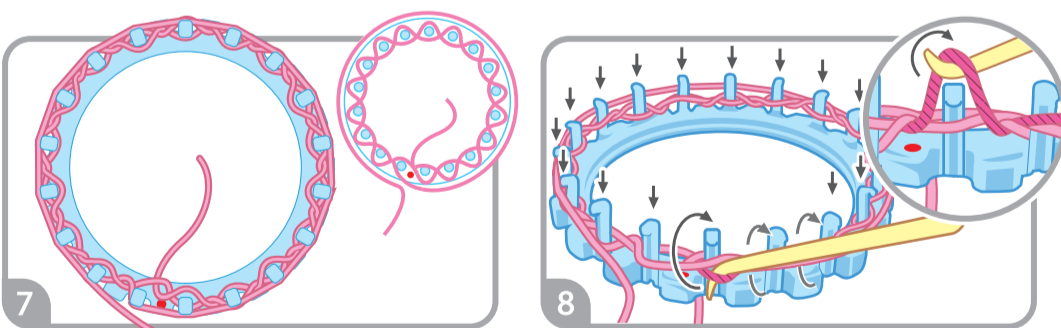

CASTING OFF:

9. After the 35 rows of yarn are knitted, cut the yarn, leaving a length of about 60 cm.
10. Use the sewing needle to thread the yarn through the loop at each prong as shown.
11. Release your work from the reel using the crochet hook.
12. Strap one end of the yarn to close one side of the knitwork.
13. Loosen the stuffing a bit and then tuck it into the pocket formed.
14. Strap to close the other end of the knitwork to form the owl body. For each end of the yarn, loop it once around any yarn nearby and tie a knot to secure it. Tuck the excess yarn into the owl body.

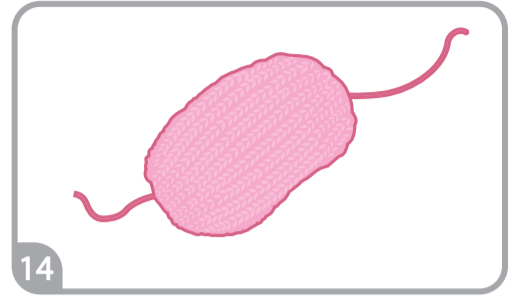
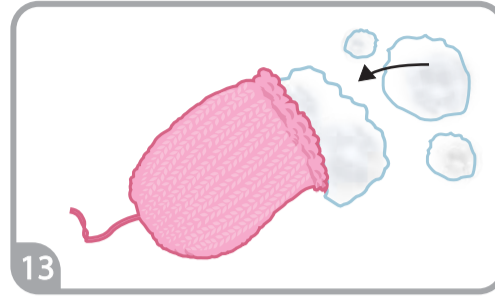
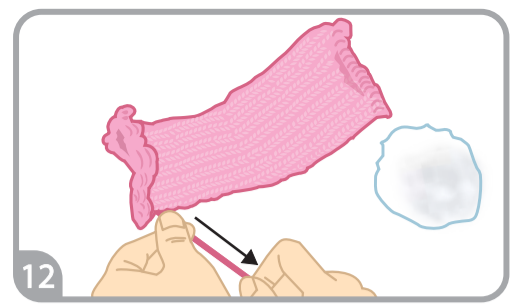
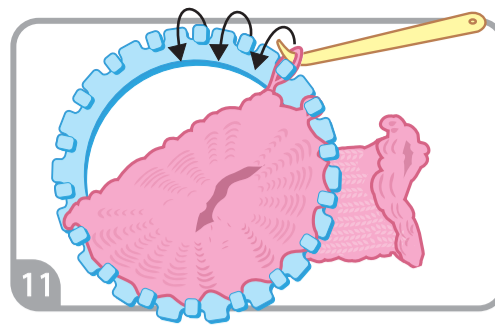
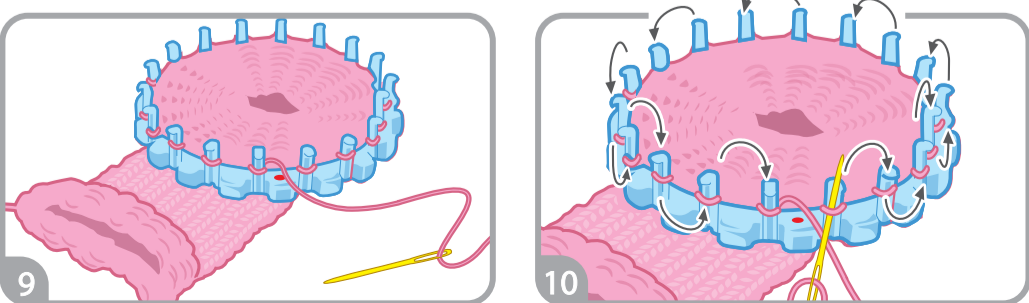

C. ADDING EMBELLISHMENTS

1. Tie the ribbon at approximately neck level around the owl body, as shown in the diagram. Adjust the ribbon so that the knot will appear at the back of the body.
2. Arrange the pre-cut eyebrow and eye shade felt pieces onto the owl face for positioning.
3. Leave the eyebrow felt on the owl face. Thread a strand of yarn of about 40cm onto the sewing needle. Tie a knot at the longer end. Loop it once around any yarn underneath the pre-cut hole of the eyebrow felt as shown. This loop is used to later secure the knitting. Thread the yarn, from the back of the felt, through the pre-cut hole, to the front. Next, thread it to the back through the second hole, and then to the front through the third hole.
4. Continue this stitching pattern until the last hole is threaded. Tie a knot to secure the felt and trim the excess yarn. The eyebrow is now attached.
5. Apply the same technique to knit the flower felt piece above the eyebrow.
6. Place the large eyeshade felt piece onto the owl face, covering the stitches done in 3 & 4. Thread a strand of yarn of about 40cm long onto the sewing needle. Tie a knot at the longer end. Loop it once around any yarn underneath the felt. Following the needle path shown in the diagram 6, thread the yarn through the eyeshade and the owl body.
7. Tie a knot to secure the felt and trim the excess yarn. This diagram shows how the finished stitches will look.
8. Line up the holes on the small and large wing felt pieces. Apply the same technique used in C6 to knit the wing sets to both sides of the owl body. Next, knit the pair of foot felt pieces at the base of the owl body.
9. Glue the remaining felt pieces onto the owl doll, as shown in the diagram. Note: For superior results, apply a sufficient amount of glue for each piece of felt. After applying the glue, allow the doll to remain undisturbed for at least a half hour for it to dry and set. Your French Knitting Owl Doll is done!

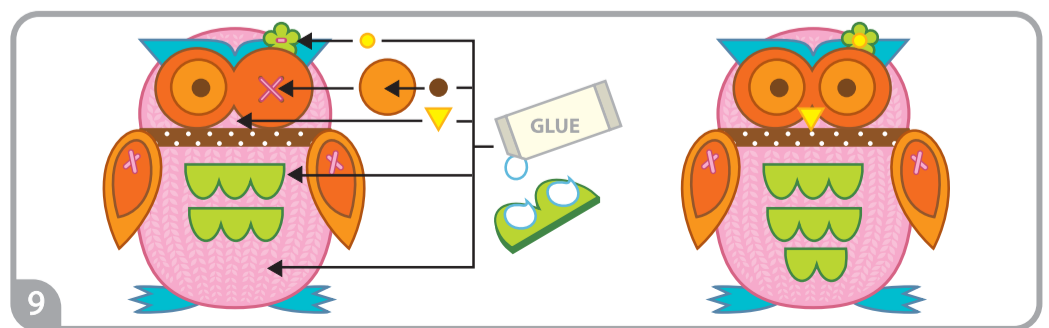
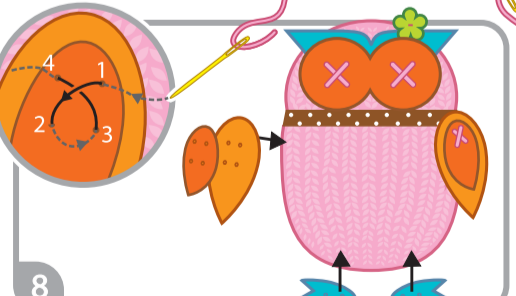
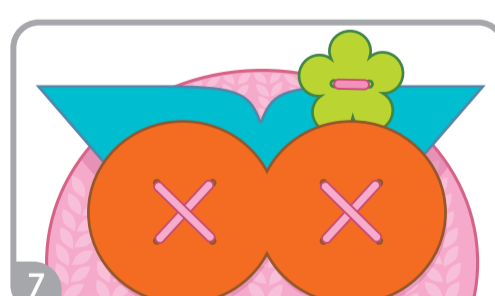
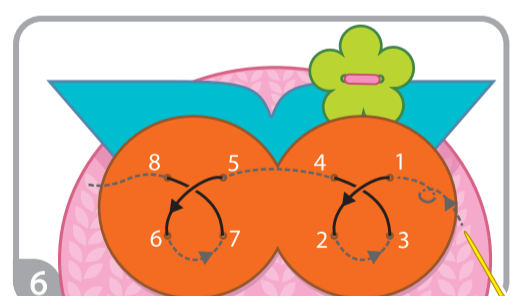
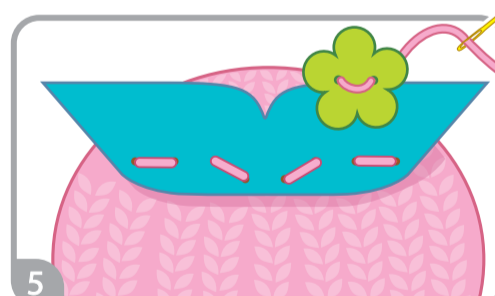
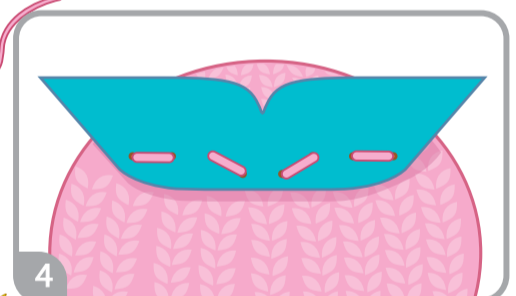
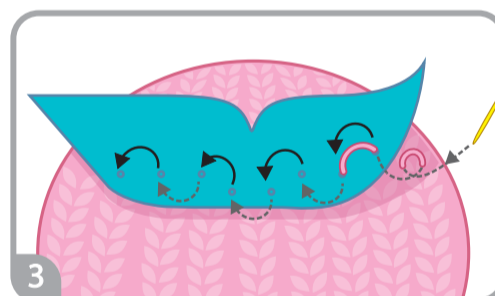
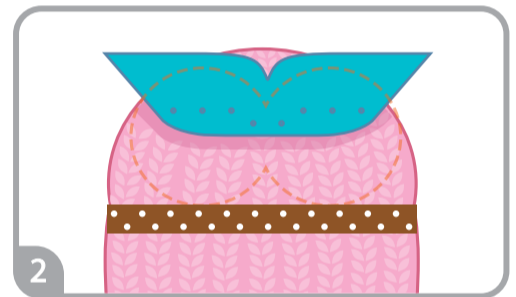
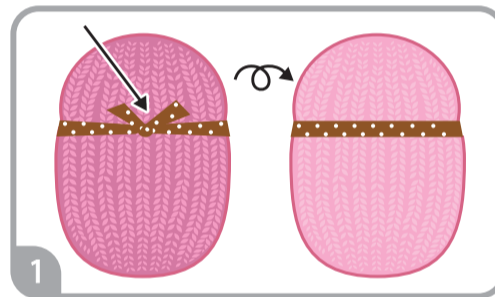

QUESTIONS & COMMENTS - We treasure you as a customer and your satisfaction with this product is important to us. In case you have any comments or questions, or you find any parts of this kit missing or defective, please do not hesitate to contact our distributor in your country, whose address is printed on the package. You are also welcome to contact our marketing support team at Email: infodesk@4M-IND.com, Fax (852) 25911566, Tel (852) 28936241, Web site: WWW.4M-IND.COM